



INSTRUCTION BULLETIN

No. 9015115
Machine: M17
Published: 07-2016
Rev. 00

NOTE: DO NOT DISCARD the Parts List from the Instruction Bulletin. Place the Parts List in the appropriate place in the machine manual for future reference. Retaining the Parts List will make it easier to reorder individual parts and will save the cost of ordering an entire kit.

NOTE: Numbers in parenthesis () are reference numbers for parts listed in Bill of Materials.

Installation instructions for **kit number 9015064**

SYNOPSIS:

This kit contains the parts needed to replace the thermal switch on M17 sweeper- scrubbers.
Please follow step-by-step instructions.

SPECIAL TOOLS / CONSIDERATIONS: NONE

(Estimated time to complete: 1 hour)

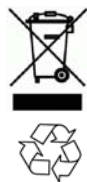

PROTECT THE ENVIRONMENT

Please dispose of packaging materials, used machine components such as batteries and fluids in an environmentally safe way according to local waste disposal regulations.

Always remember to recycle.

PREPARATION:

1. Park the machine on a clean level surface, set the parking brake, completely raise the hopper, and engage the hopper support bar.

 **WARNING: Raised hopper may fall. Engage hopper support bar.**

 **WARNING: Lift arm pinch point. Stay clear of hopper lift arms.**

FOR SAFETY: When using machine, make sure adequate clearance is available before raising hopper. Do not raise hopper when machine is on an incline.

2. Lower the hopper until the hopper support bar rests on the support bar stop, turn off the machine, and remove the key

FOR SAFETY: Before leaving or servicing machine, stop on level surface, turn off machine, and remove key.

3. Disconnect the battery cable from the machine.

 **WARNING: Always disconnect battery cables from machine before working on electrical components.**

4. Remove the perma-filter panel from the hopper weldment. Set the perma-filter panel and all mounting hardware aside. (Fig. 1)

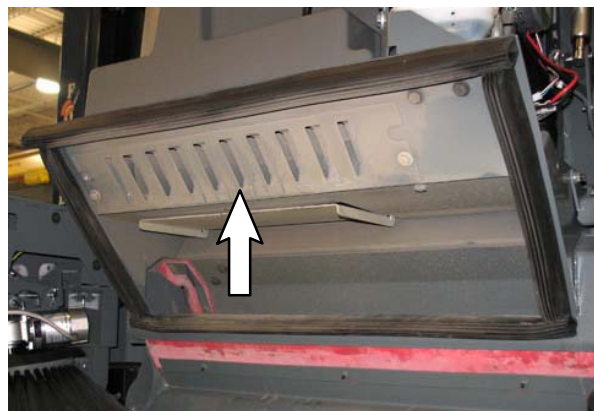

FIG. 1

INSTALLATION:

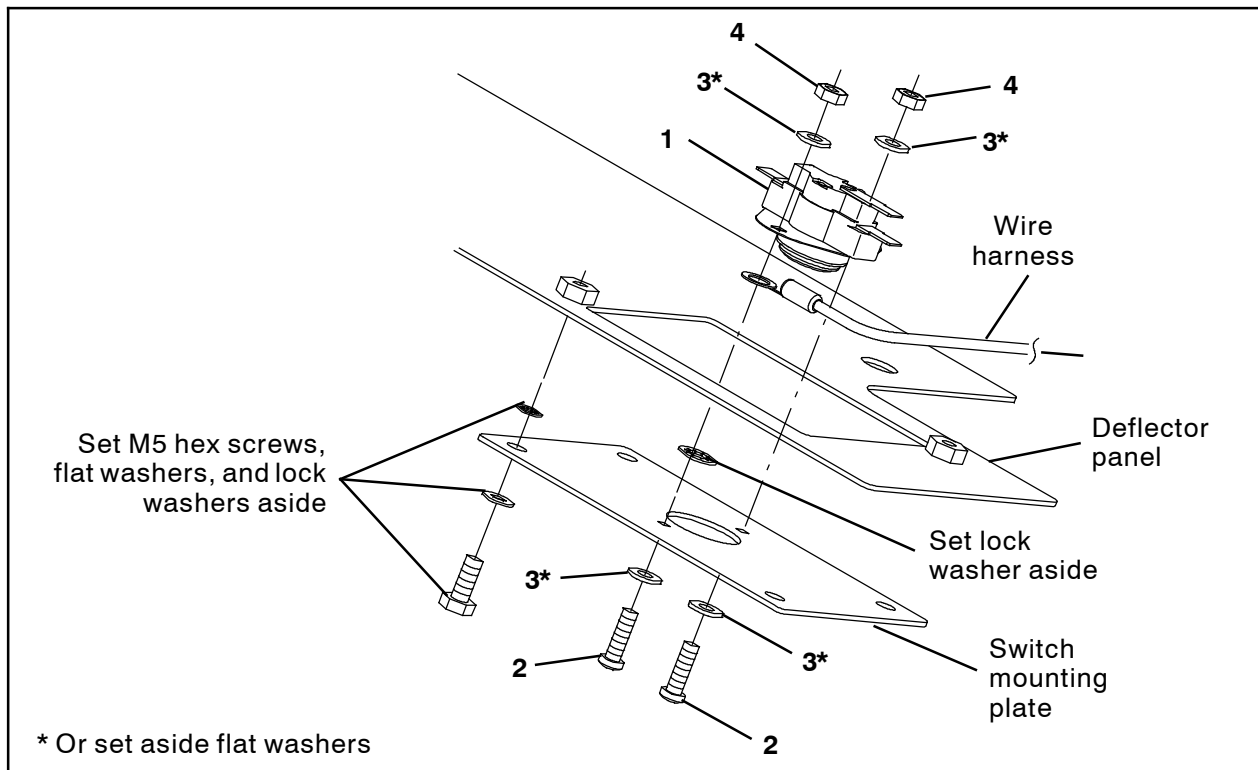

FIG. 2

1. Remove the switch mounting plate from the hopper deflector plate. Set M5 hex screws, flat washers, and lock washers aside. (Fig. 2 / Fig. 3)
2. Remove the existing thermal switch from the switch mounting plate. Set the lock washer and two flat washers aside. Discard the thermal switch, both M4 pan screws, both M4 nuts, and the remaining flat washers. (Fig. 2)
3. Use two M4 pan screws (2), two flat washers (3), two saved flat washers, the lock washer, and two M4 hex nuts (4) to install the thermal switch (1) and wire harness onto the switch mounting plate. (Fig. 2)
4. Reinstall the switch mounting plate onto the hopper deflector plate. (Fig. 2 / Fig. 3)
5. Reinstall the perma-filter panel onto the hopper.
6. Reconnect the battery cable to the machine.
7. Start the machine, disengage the hopper support bar. and lower the hopper.
8. Test the machine. Observe for a thermal switch fault code. If there is a fault code, ensure the circuit breaker does not need to be reset. If necessary, reset the circuit breaker.

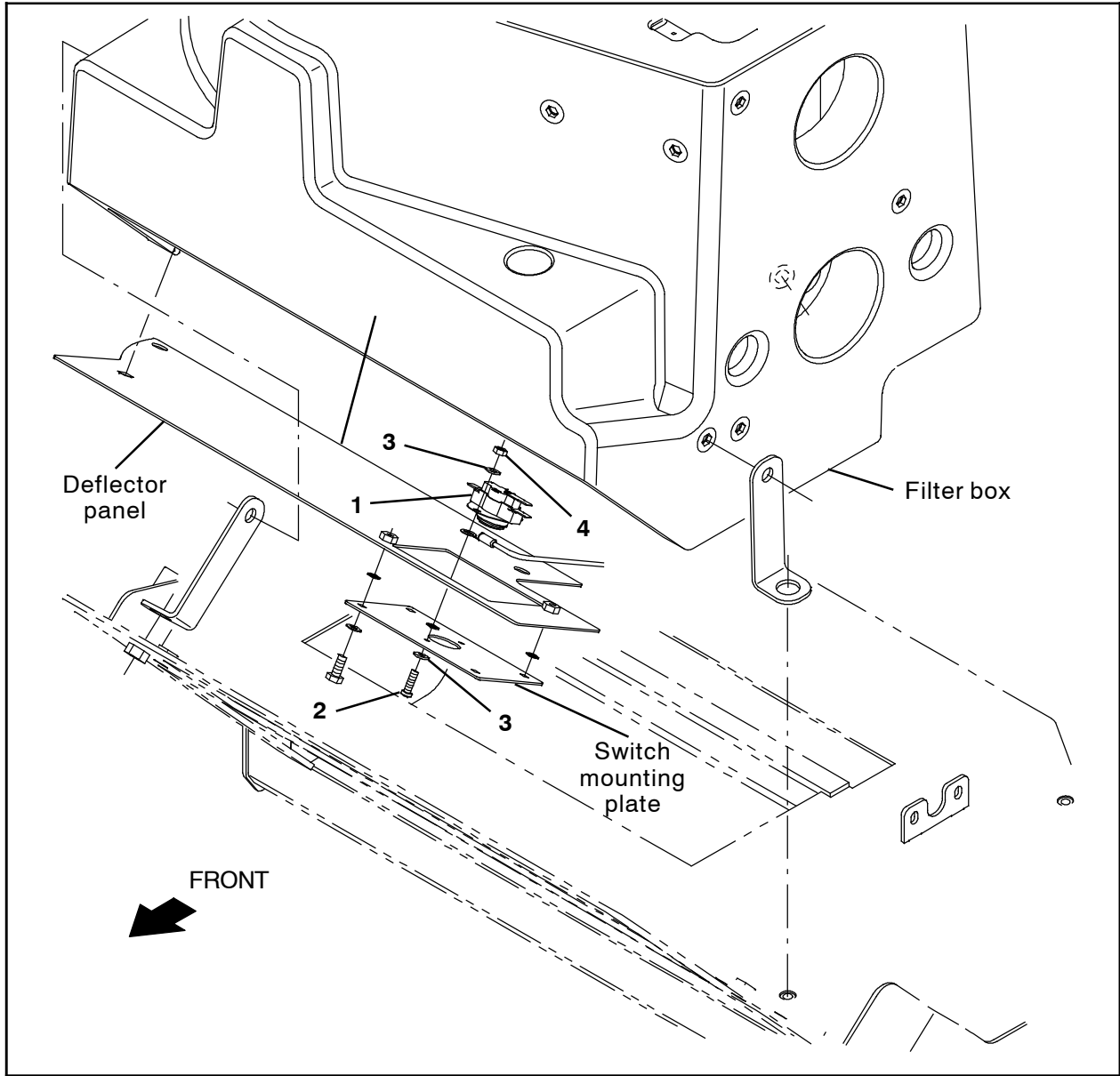

FIG. 3

Bill Of Materials For Switch Kit, Thermal, Afmkt [M17] - 9015064

Ref.	Tennant Part No.	Description	Qty.
1	367679	Switch, Thermal, 160DEG, SPDT	1
2	06927	Screw, Pan, Phl, M4 X 0.70 X 16, 4.8	2
3	19065	Washer, Flat, 0.19B 0.44D .05, PL, 08	2
4	02850	Nut, Hex, Lock, M4 X 0.70, NL	2

TENNANT COMPANY
P. O. Box 1452
Minneapolis, MN 55440-1452